

# SH\_\_-7,62-K-S

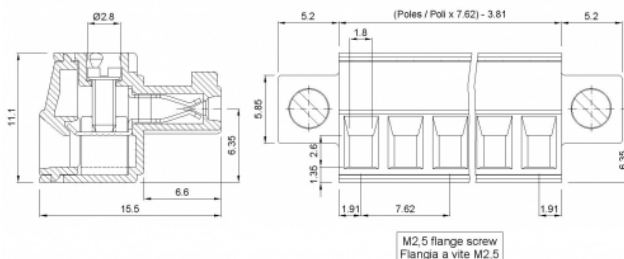

## GENERAL INFORMATION

pitch	7,62 mm
Height	11.1 mm
Depth	15.5 mm
Dimensional class	Media
Wire section	2.5 mm <sup>2</sup> / 14 AWG
Clamp opening size	1.8 x 2.6 mm
Wire stripping	max 8 mm
Operating temperature	-40 ÷ +130 °C

## ELECTRICAL CHARACTERISTICS

Current	11 A
Voltage	500 V
impulse voltage	6 kV

## MECHANICAL CHARACTERISTICS

Screw	M2
Recommended torque	0.25÷0.27 Nm / 2.3÷2.5 in.lbs

## APPROVALS DATA



		EN 61984	UL 1059
Current	-	11 A	11 A factory / 11 A field
Voltage	-	500 V	300 V
Wire section	-	2.5 mm <sup>2</sup>	14 AWG
Torque	-	0.25 Nm	2.3 Lb-in
FILE	-	40048261	E178356

## MATERIALS

Housing	PA - UL 94 V0
Screw	Galvanized steel
Clamp	Nickel-plated copper alloy
Terminal	Copper alloy
SCIP Number	2b16c5e0-b81c-4d1f-839d-5472703af01d

## COLOURS

Standard

On request

**GN**

**GY**

**BK**

**BL**

**RD**

**YL**

**OG**

POLES	NAME	3D FILE
02	SH02-7,62-K-S	File available
03	SH03-7,62-K-S	File available
04	SH04-7,62-K-S	File available
05	SH05-7,62-K-S	File available
06	SH06-7,62-K-S	File available
07	SH07-7,62-K-S	File available
08	SH08-7,62-K-S	File available
09	SH09-7,62-K-S	File available
10	SH10-7,62-K-S	File available
11	SH11-7,62-K-S	File available