

# MPT275-P

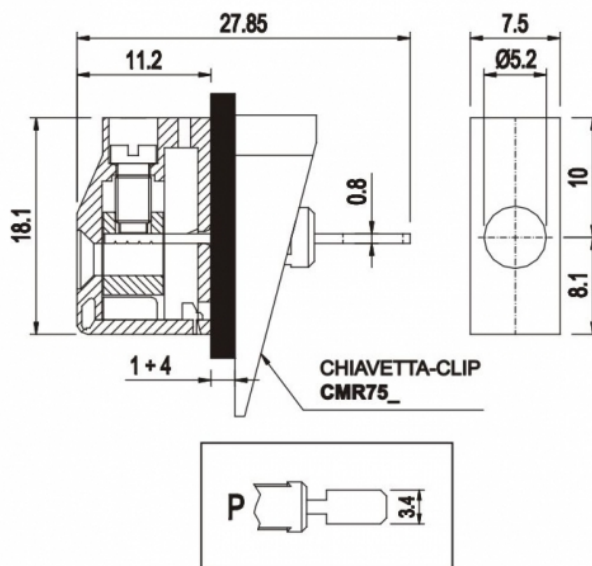

## GENERAL INFORMATION

|                       |                              |
|-----------------------|------------------------------|
| pitch                 | 7,5 mm                       |
| Height                | 18.1 mm                      |
| Depth                 | 11.2 mm                      |
| Dimensional class     | Media                        |
| Wire section          | 2.5 mm <sup>2</sup> / 14 AWG |
| Clamp opening size    | -                            |
| Wire stripping        | max 10 mm                    |
| Operating temperature | -40 ÷ +130 °C                |

## ELECTRICAL CHARACTERISTICS

|         |       |
|---------|-------|
| Current | 24 A  |
| Voltage | 450 V |

## MECHANICAL CHARACTERISTICS

|                    |                              |
|--------------------|------------------------------|
| Screw              | M3                           |
| Recommended torque | 0.5÷0.55 Nm / 4.5÷4.9 in.lbs |

## APPROVALS DATA



|              | EN 60998-1          | EN 60998-1          | UL 1059                   |
|--------------|---------------------|---------------------|---------------------------|
| Current      | 24 A                | 24 A                | 28 A factory / 20 A field |
| Voltage      | 450 V               | 450 V               | 300 V                     |
| Wire section | 2.5 mm <sup>2</sup> | 2.5 mm <sup>2</sup> | 12 AWG                    |
| Torque       | 0.5 Nm              | 0.5 Nm              | 4.5 Lb-in                 |
| FILE         | CA02.00600          | 40014733            | E178356                   |

## MATERIALS

|          |                            |
|----------|----------------------------|
| Housing  | PA - UL 94 V0              |
| Screw    | Galvanized steel           |
| Clamp    | Nickel-plated copper alloy |
| Terminal | Tin-plated copper alloy    |

**COLOURS**

Standard



On request



**POLES**

01

**NAME**

MPT275-P

**3D FILE**

File available